



UNITED
TECHNOLOGIES
CARRIER
TRANSCOLD

Carrier Transcold Division
Carrier Corporation
P.O. Box 4805
Syracuse, New York 13221

THIS DOCUMENT IS THE PROPERTY OF CARRIER CORPORATION
AND IS DELIVERED UPON THE EXPRESS CONDITION THAT THE
CONTENTS WILL NOT BE DISCLOSED OR USED WITHOUT CARRIER
CORPORATION'S WRITTEN CONSENT.

SUBMISSION OF THESE DRAWINGS OR DOCUMENTS
DOES NOT CONSTITUTE PART PERFORMANCE OR
ACCEPTANCE OF CONTRACT

PART NO.	MODEL DESCRIPTION
98-03219-00	ELECTRIC HEAT ONLY

ELECTRIC HEAT INSTALLATION PROCEDURE

CAUTION: TURN THE UNIT OFF, DISCONNECT THE BATTERY & ALLOW SUFFICIENT TIME FOR THE ENGINE & ITS FLUIDS TO COOL BEFORE PROCEEDING.

NOTE: IT IS EXTREMELY IMPORTANT THAT THE UNIT REMAIN DISABLED THROUGHOUT THIS PROCEDURE.

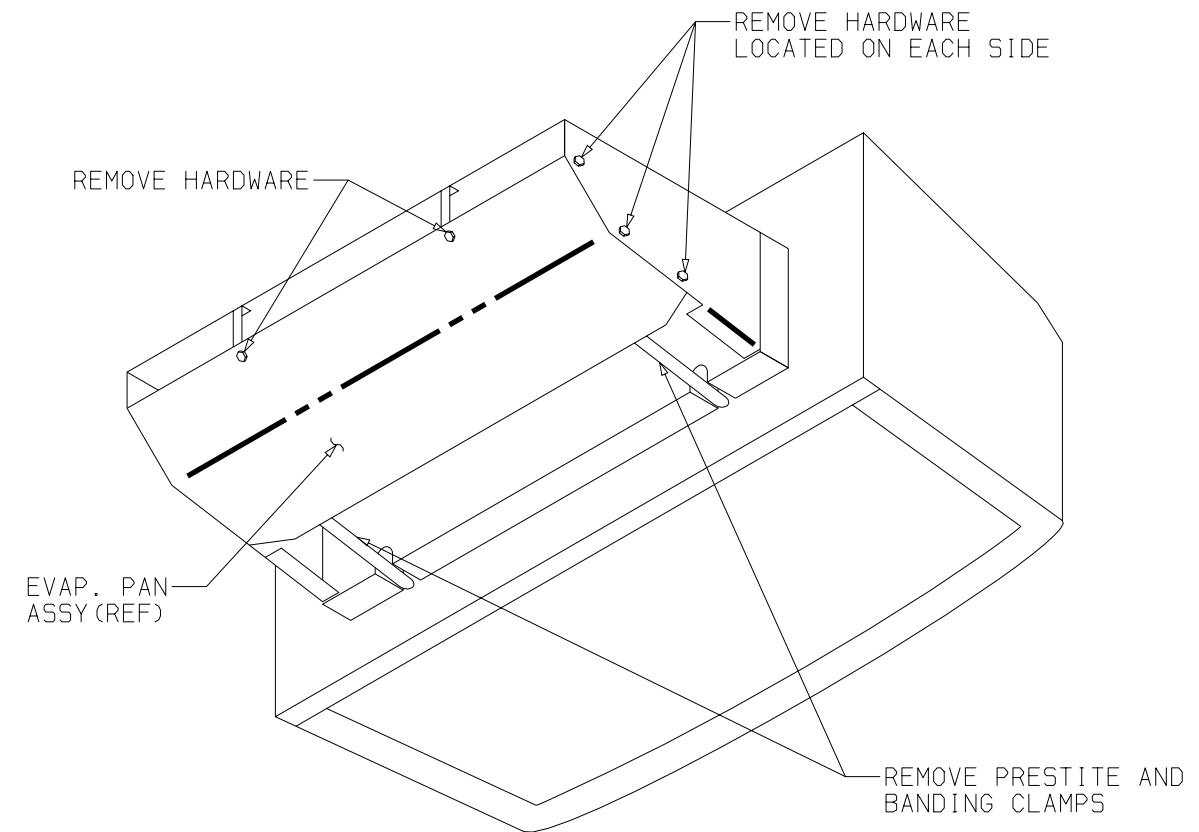

- 1.) REMOVE EVAPORATOR DRAIN PAN ASSEMBLY FROM UNIT (RETAIN HARDWARE FOR RE-ASSEMBLY). ONCE THE DRAIN PAN HAS BEEN REMOVED, REMOVE THE EXISTING PRESTITE (IF PRESENT) FROM THE DRIP PAN OF THE EVAPORATOR.

(CONTINUED ON NEXT SHEET)

SHEET INDEX

DESCRIPTION	SHEET NO.	REVISION
DRAIN PAN REMOVAL	1	-
HEATER MOUNTING	2	-
JUNCTION BOX WIRING	3	-
HEATER BOX INSTALLATION	4	-
HTR BOX/MAIN CONTROL BOX WIRING	5	-

SEE SEPARATE PARTS LIST

-	INITIAL RELEASE PER PCA71N2126P01					MGC	7-24-98	SUPERSEDES	TITLE	INSTALLATION INSTRUCTIONS 6722/44 ELECTRIC HEAT KIT	DRAWING NO.	98-03219	REV	-
SYM	REVISION RECORD	ENGRG.	DATE	APPLICATION ENGRG.	DATE	DRAWN BY	DATE					SHT. 1 OF 5		

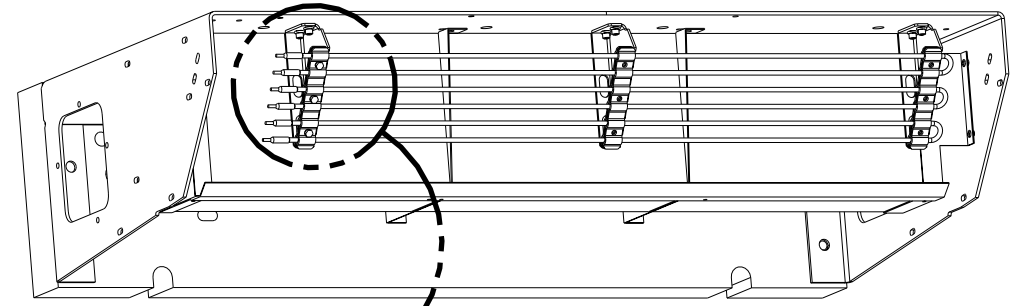

HEATER MOUNTING

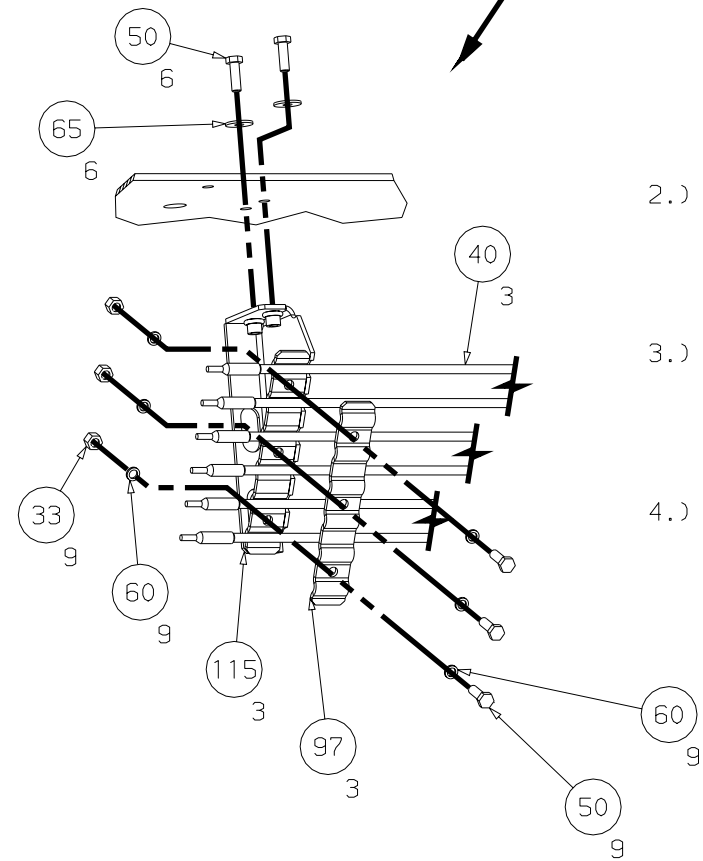

- 2.) LOOSELY ASSEMBLE THE HEATERS (IT.40) TO THE HEATER BRACKET ASSY'S (IT.115) WITH HARDWARE SHOWN. NOTE: THE SMALLER WASHERS (IT.60) SHOULD BE USED TO MOUNT THE HEATERS.
- 3.) LOOSELY INSTALL THE ASSEMBLY INTO THE EVAPORATOR WRAPPER MAKING CERTAIN EACH BRACKET ALLIGNS CORRECTLY WITH THE EVAPORATOR WRAPPER MOUNTING HOLES.
- 4.) TIGHTEN ALL HARDWARE. IT MAY BE NECESSARY TO REMOVE THE ASSEMBLY IN ORDER TO TIGHTEN THE BOLTS THAT SECURE THE HEATERS. REINSTALL ASSEMBLY.

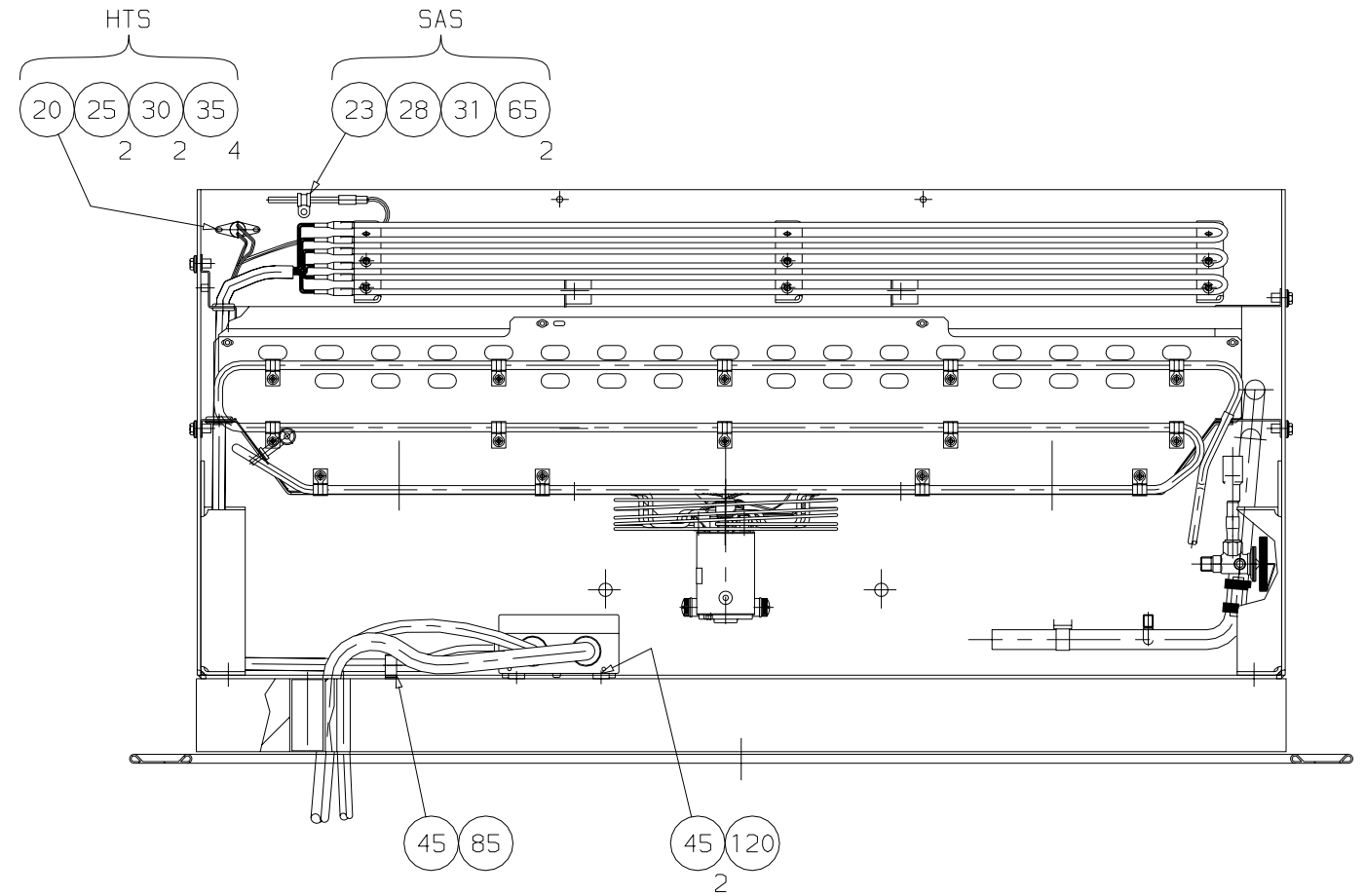

FIGURE A

- 5.) MOUNT THE SUPPLY AIR SENSOR (SAS (IT.23)) AND THE HIGH TEMPERATURE SAFETY (HTS (IT.20)) TO THE EVAPORATOR WRAPPER AS SHOWN IN "FIGURE A".
- 6.) REMOVE THE JUNCTION BOX (IT.120) COVER & LOCATE THE BOX INSIDE THE BULKHEAD AS SHOWN IN "FIGURE B".
- 7.) MARK THE POSITION OF THE MOUNTING HOLES. USING A #8 (0.199 DIA) DRILL BIT, DRILL THE TWO HOLES FOR THE BOX & THE ONE HOLE FOR THE CLAMP.
- 8.) MOUNT THE JUNCTION BOX & CLAMP (SEE "FIGURE A").

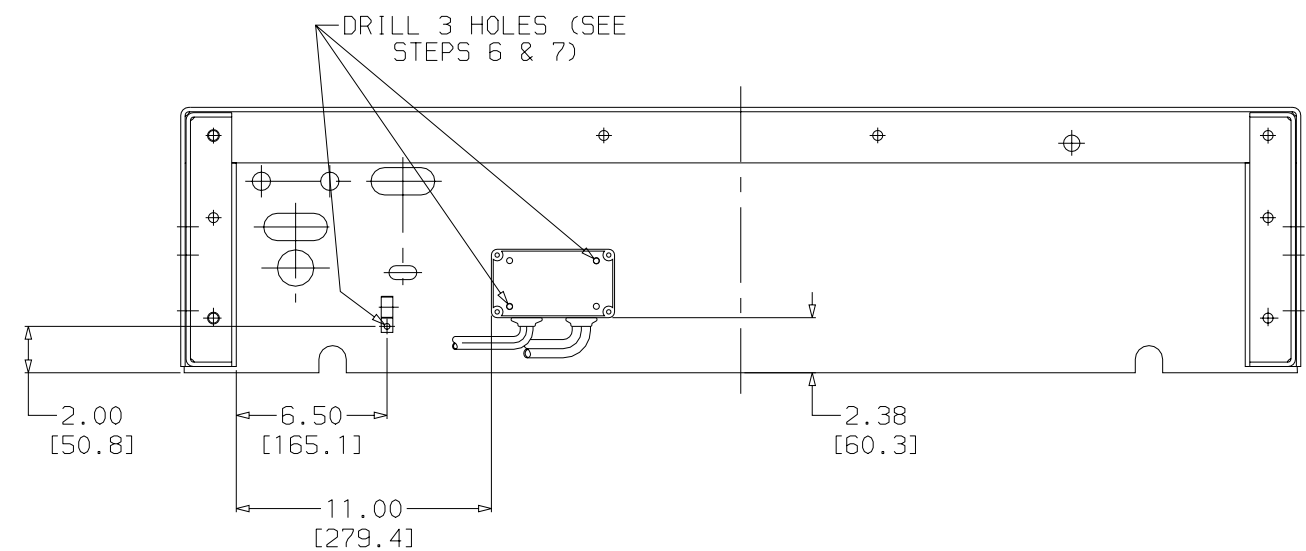

FIGURE B

(CONTINUED ON NEXT SHEET)

-	INITIAL RELEASE PER PCA71N2126P01					MGC	7-24-98	SUPERSEDES	TITLE	INSTALLATION INSTRUCTIONS SUPRA 6/722/44 - ELECTRIC HEAT KIT	DRAWING NO. 98-03219	REV -
SYM	REVISION RECORD	ENGRG.	DATE	APPLICATION ENGRG.	DATE	DRAWN BY	DATE				SHT. 2 OF	



UNITED
TECHNOLOGIES
CARRIER
TRANSCOLD

Carrier Transcold Division
Carrier Corporation
P.O. Box 4805
Syracuse, New York 13221

THIS DOCUMENT IS THE PROPERTY OF CARRIER CORPORATION
AND IS DELIVERED UPON THE EXPRESS CONDITION THAT THE
CONTENTS WILL NOT BE DISCLOSED OR USED WITHOUT CARRIER
CORPORATION'S WRITTEN CONSENT.

SUBMISSION OF THESE DRAWINGS OR DOCUMENTS
DOES NOT CONSTITUTE PART PERFORMANCE OR
ACCEPTANCE OF CONTRACT

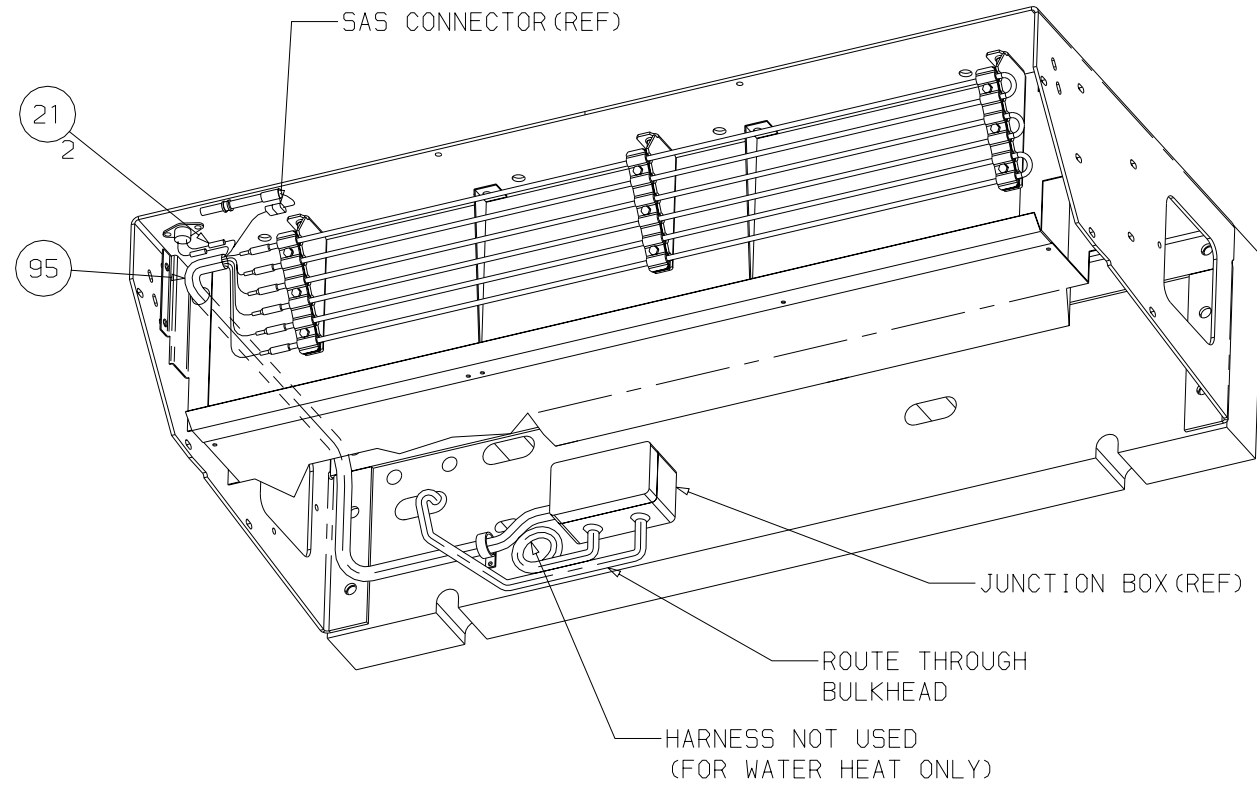

- 9.) USE THE WIRE ASSEMBLY SUPPLIED (MARKED 2HT1) TO CONNECT THE HTS. USE BUTT SPLICES (IT.21) TO MAKE THE CONNECTIONS.
- 10.) PLUG THE SAS INTO THE EXISTING HARNESS CONNECTOR.
- 11.) SEPARATE THE HEATER WIRES INTO PAIRS OF EACH HEATER ROD. TAPE EACH PAIR TOGETHER.
- 12.) ROUTE THE HEATER WIRES ALONG WITH THE HTS WIRES THROUGH THE SPLIT TUBING (IT.95) AND THROUGH THE COIL AS SHOWN. ROUTE THE WIRES TO THE "JUNCTION BOX".
- 13.) REMOVE THE FLAG TERMINALS LOCATED ON THE HTS (2HT1) WIRES.
- 14.) TRIM ALL WIRES TO THE APPROPRIATE LENGTHS TO MAKE CONNECTIONS INSIDE OF THE JUNCTION BOX. TRIM 1/4" OFF OF EACH WIRE & MAKE CONNECTIONS AS SHOWN IN THE "JUNCTION BOX DIAGRAM".
- 15.) ROUTE THE HARNESS SHOWN THROUGH THE EVAPORATOR BULKHEAD. ADD CAULKING AROUND THE OPENING TO PREVENT AIR LEAKS.
- 16.) ADD TY-WRAPS (IT.75) AS REQUIRED TO SUPPORT LOOSE HARNESES.
- 17.) REINSTALL DRAIN-PAN USING PREVIOUSLY REMOVED HARDWARE & NEW PRESTITE (IT.8).

(CONTINUED ON NEXT SHEET)

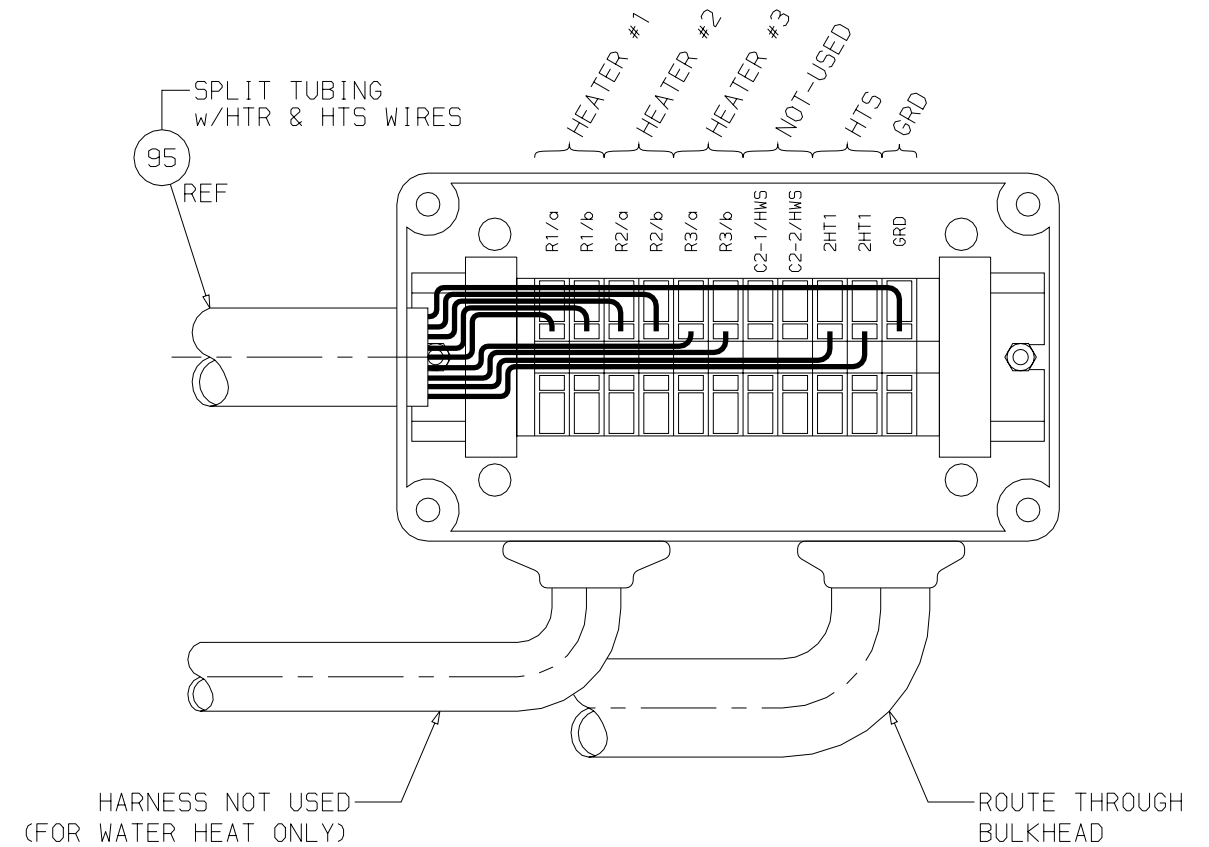

JUNCTION BOX DIAGM

24-OCT-2001 07:04:31 etct03*

-	INITIAL RELEASE PER PCA71N2126P01					MGC	7-24-98	SUPERSEDES	TITLE	INSTALLATION INSTRUCTIONS SUPRA 6/722/44 - ELECTRIC HEAT KIT	DRAWING NO. 98-03219	REV -
SYM	REVISION RECORD	ENGRG.	DATE	APPLICATION ENGRG.	DATE	DRAWN BY	DATE				SHT. 3 OF	



UNITED TECHNOLOGIES CARRIER TRANSCOLD
 Carrier Transicold Division
 Carrier Corporation
 P.O. Box 4805
 Syracuse, New York 13221

THIS DOCUMENT IS THE PROPERTY OF CARRIER CORPORATION AND IS DELIVERED UPON THE EXPRESS CONDITION THAT THE CONTENTS WILL NOT BE DISCLOSED OR USED WITHOUT CARRIER CORPORATION'S WRITTEN CONSENT.

SUBMISSION OF THESE DRAWINGS OR DOCUMENTS DOES NOT CONSTITUTE PART PERFORMANCE OR ACCEPTANCE OF CONTRACT

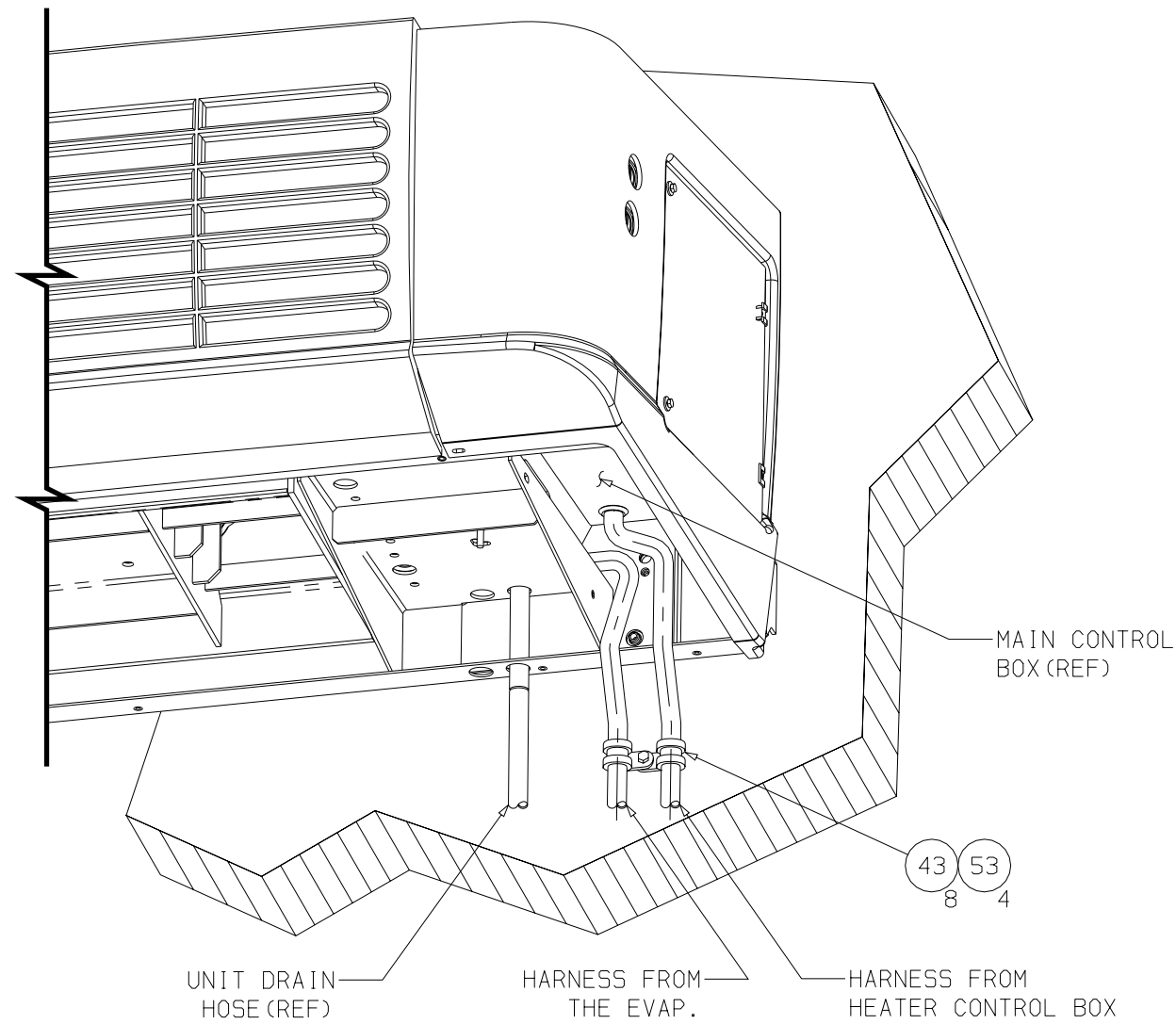

- 18.) ROUTE THE WIRES THROUGH THE BOTTOM OF THE UNIT DOWN THE FRONT OF THE TRUCK BODY.
- 19.) REFER TO "HEATER BOX INSTALL." FOR MOUNTING THE "HEATER CONTROL BOX(IT.10)".
- 20.) ROUTE THE HARNESS FROM THE EVAPORATOR JUNCTION BOX TO THE "HEATER CONTROL BOX". ROUTE THE HEATER CONTROL BOX HARNESS TO THE "MAIN CONTROL BOX".
- 21.) SECURE THE HARNESSES TO THE TRUCK WALL WITH CLAMPS(IT.43) & HARDWARE(IT.53).

(CONTINUED ON NEXT SHEET)

HEATER BOX INSTALL.

REMOVE THE LID OF CONTROL BOX(IT.10) & USE THE BOX AS A TEMPLATE TO MOUNT THE CONTROL BOX TO THE TRUCK BOX IN LOCATION DESIRED. USE FOUR(4) SCREWS(IT.53) TO MOUNT THE BOX.

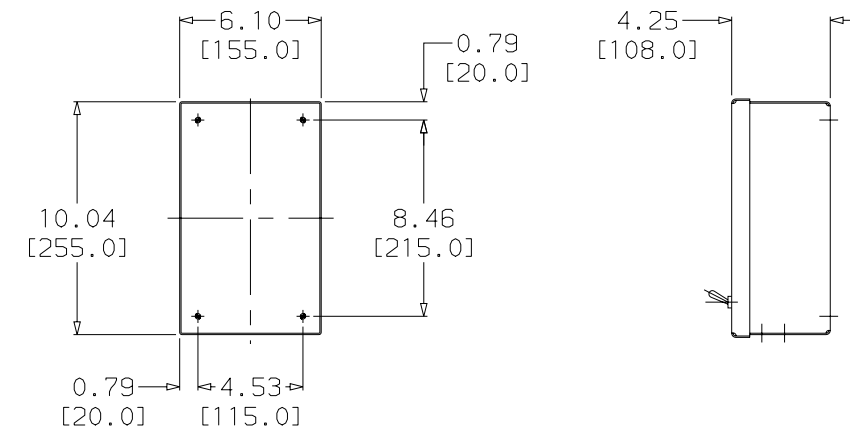
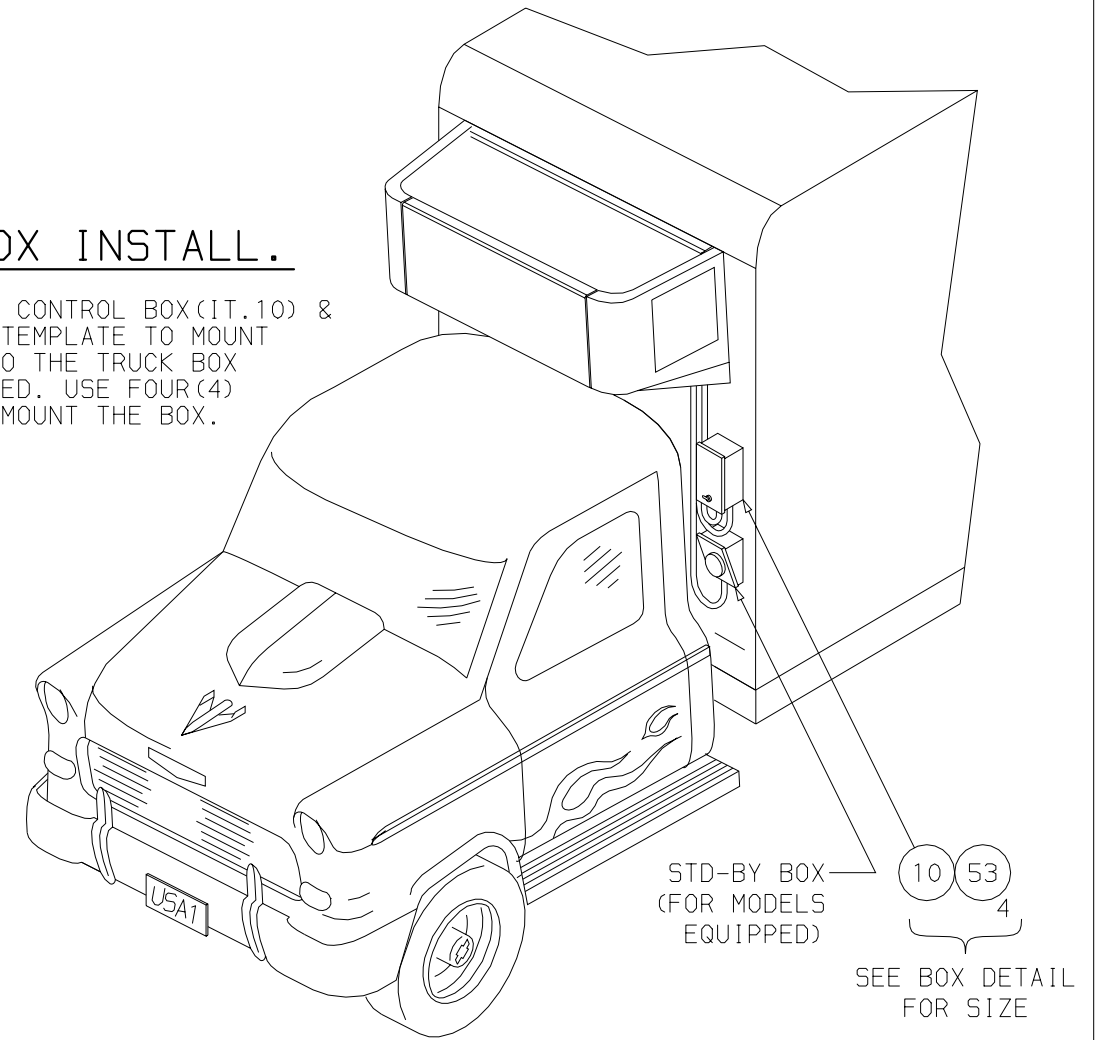

SHOWN w/o DOOR

BOX DETAIL

-	INITIAL RELEASE PER PCA71N2126P01					MGC	7-24-98	SUPERSEDES	TITLE	INSTALLATION INSTRUCTIONS SUPRA 6/722/44 ELECTRIC HEAT KIT	DRAWING NO. 98-03219	REV -
SYM	REVISION RECORD	ENGRG.	DATE	APPLICATION ENGRG.	DATE	DRAWN BY	DATE				SHT. 4 OF	

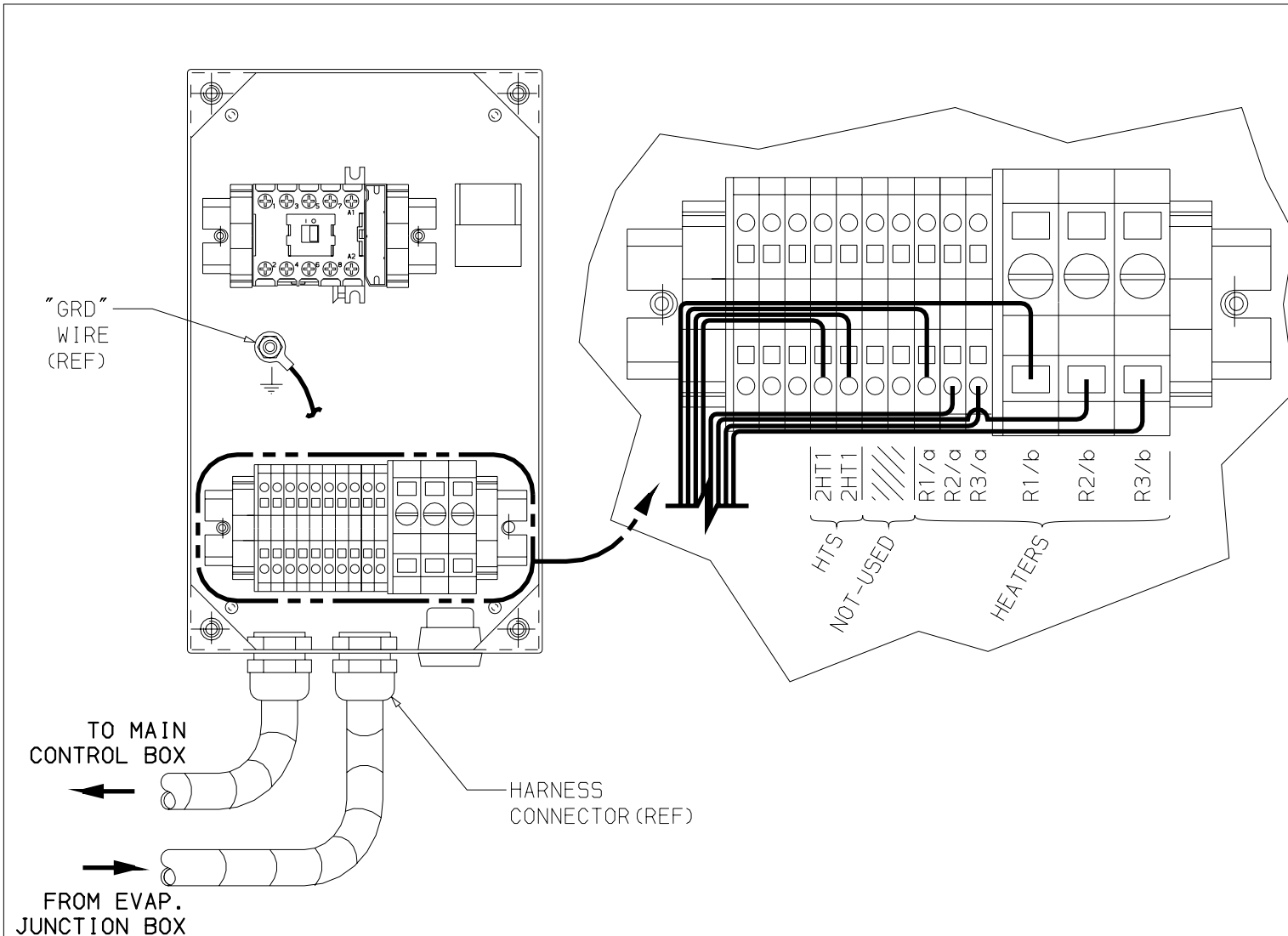

- 22.) SECURE THE HARNESS CONNECTOR TO THE "HEATER CONTROL BOX".
- 23.) INSTALL THE GROUND WIRE "GRD" TO THE GROUND STUD. STRIP 1/4" OF INSULATION FROM EACH WIRE AND MAKE REQUIRED CONNECTIONS.

ASSEMBLY NOTE: MAKE SURE THAT EACH PAIR OF HEATER WIRES ARE INSTALLED CORRECTLY.
EXAMPLE: INSTALL EACH PAIR OF WIRES ONE AT A TIME BY REMOVING THE TAPE FROM ONE PAIR AND INSTALL ONE WIRE INTO R1/a AND THE OTHER INTO R1/b. THE NEXT PAIR SHOULD BE INSTALLED ONE WIRE INTO R2/a AND THE OTHER INTO R2/b. THE LAST PAIR SHOULD USE ONE WIRE INTO R3/a AND THE OTHER INTO R3/b.

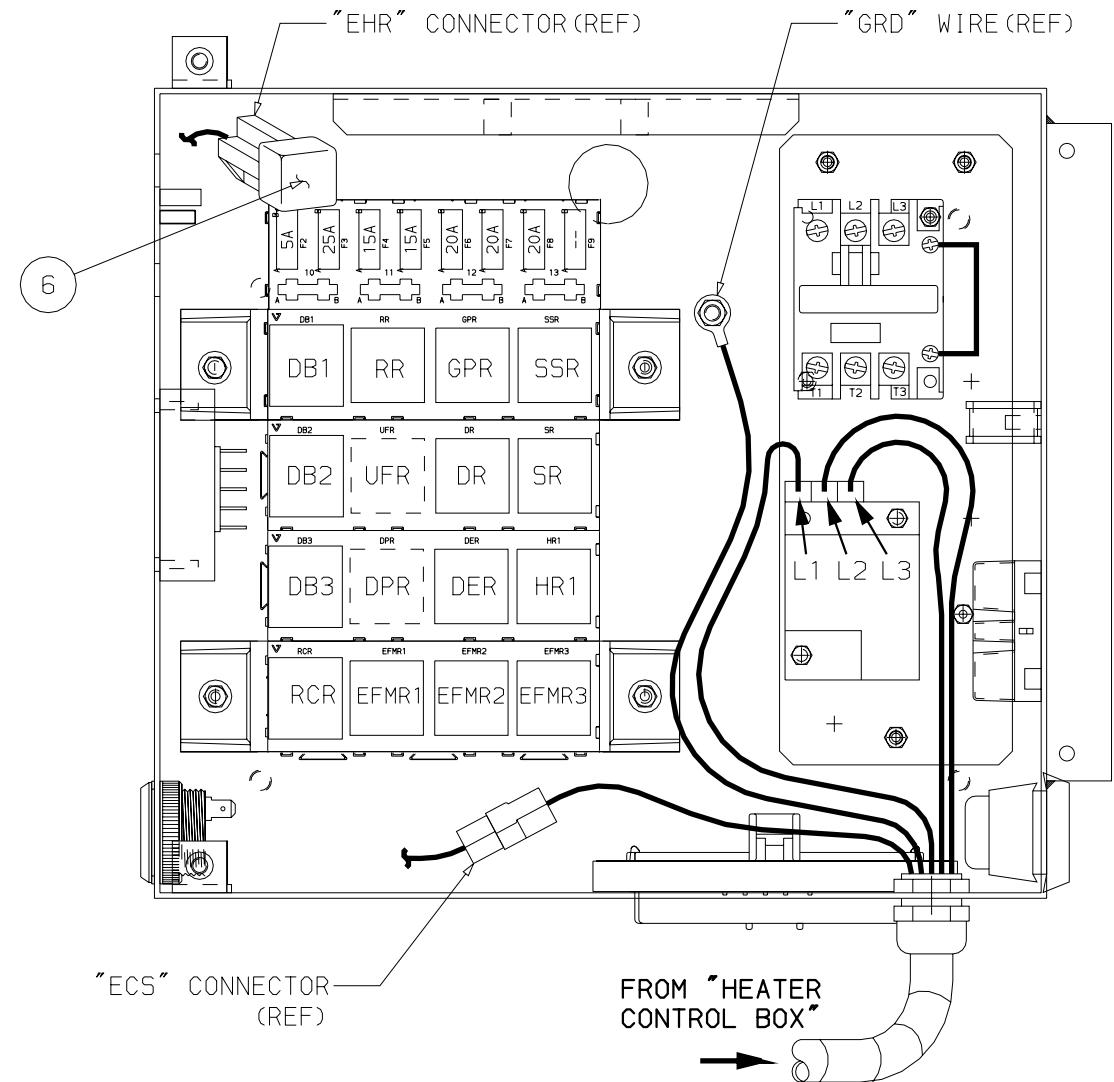

- 24.) SECURE THE HARNESS CONNECTOR TO THE "MAIN CONTROL BOX".
- 25.) INSTALL THE GROUND WIRE "GRD" TO THE GROUND STUD.
- 26.) FIND THE CONNECTOR WITH WIRES MARKED "EHC" INSIDE THE LOWER PORTION OF THE "MAIN CONTROL BOX" AND PLUG IN THE CONNECTOR.
- 27.) INSTALL THE RED WIRES MARKED L1, L2 & L3 INTO THE OVERLOAD AS SHOWN.
- 28.) FIND THE CONNECTOR WITH WIRES MARKED "EHR" INSIDE THE UPPER PORTION OF THE CONTROL BOX AND INSTALL THE RELAY (IT.6).
- 29.) RECONNECT THE UNIT BATTERY AND RUN-TEST THE UNIT CHECKING FOR PROPER OPERATION.
- 30.) REINSTALL ALL CONTROL BOX DOORS/PANELS.

-	INITIAL RELEASE PER PCA71N2126P01					MGC	7-24-98	SUPERSEDES	TITLE	INSTALLATION INSTRUCTIONS SUPRA 6/722/44 ELECTRIC HEAT KIT	DRAWING NO. 98-03219	REV -
SYM	REVISION RECORD	ENGRG.	DATE	APPLICATION ENGRG.	DATE	DRAWN BY	DATE				SHT. 5 OF	